



# Datasheet

## 8-inch Shallow Base (SHB-8)

## General

TKH Airport Solutions shallow bases are designed for use with various types of 8" inset lights. The light fixtures can be supplied with a standard edge thickness of 19 mm, or optionally with a different edge thickness. The bases are prepared with a nut for an O-ring if a watertight construction is required. The bases are made of corrosion-proof aluminum alloy.

## Key features

- Easy to install, light weight
- Made of corrosion-proof aluminium alloy
- Optimized thermal conductivity, increasing the operating life of the inset lights
- Easy connection between base and wiring system provided by 110 mm bottom hole
- Provided with an earth point (M6 mm)

## Standards

The TKH Airport Solutions 8" shallow base has been developed in accordance with the following standards:

- FAA AC 150 / 5345 – 46 and 42 (current edition) for direct mounting of inset lights

## Technical Drawing

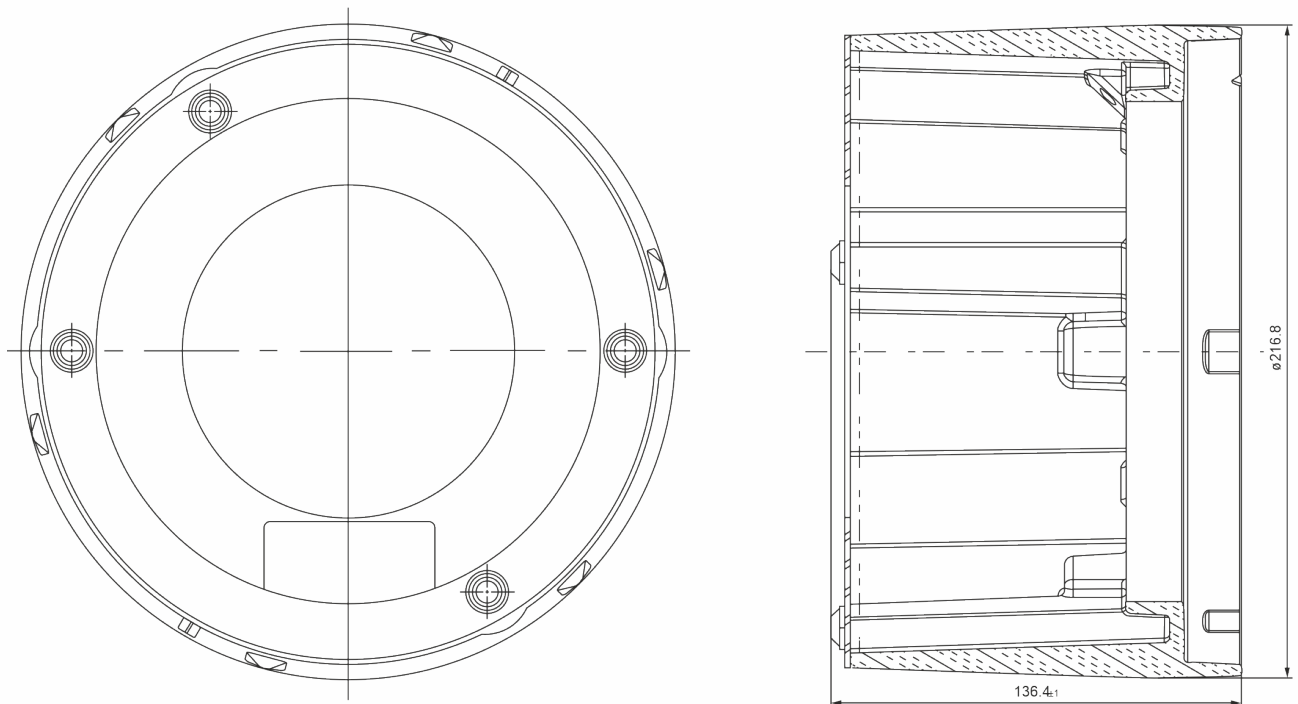

## Accessories

- Mounting kit for 8" shallow base including 2 screws, 2 anti-rotation pins, and 2 washers, either:
  - 213.694-007 (with Nord-Lock washers), or
  - 213.694-017 (with standard washers)
- Earthing kit for 8" shallow base (215.073-007)
- Installation tool for 8" shallow base (302.221/1)
- Telescope kit for directional adjustment of shallow base (302.222)

## Packing data

### 8" shallow base

Packing material	Dimensions	Gross weight	Net weight	Net each
Max. 90 pcs bulk in a cardboard box on a pallet	Max. 120 x 80 x 110 cm	255.0 kg	225.0 kg	2.5 kg

## Ordering code

Option	Key	Description	SHB	-	8	-	0	-	I	-	0	000	S	-	D	-	000
<b>Version</b>																	
	SHB	Shallow Base															
<b>Size</b>																	
	8	8 Inch															
<b>Thread holes</b>																	
	0	Blind hole															
	1	Through hole															
<b>Thread inset screws</b>																	
	I	Stainless steel insets															
	S	Threaded pin (Studs)															
	C	Coil (e.g. Helicoil)															
<b>Surface treatment</b>																	
	0	No															
<b>Cable input</b>																	
	000	Bottom hole															
	A00	Cable bushing side entry (sealed) position A (direction A)															
	A90	Cable bushing side entry (sealed) position A+90° (across to driving direction)															
	B00	Cable bushing side entry (sealed) position B (direction B)															
	A/B	Cable bushing sideways (sealed) two Plug A + B (side A/B)															
<b>Depth</b>																	
	S	Standard															
<b>Material</b>																	
	D	Die casting															
<b>Features</b>																	
	000	Not defined															

## Document Information

Name : 04\_LED\_8\_Inch\_Shallow\_Base\_Type\_SHB\_03-71073  
 Version : V1.5  
 Language : English (Original manual)

For the latest version of this document see <https://www.tkh-airportsolutions.com/airfield-products/> or scan:





### Company profile:

TKH Airport Solutions is an innovator in airfield ground lighting, offering a complete range of LED AGL products. We build upon the know-how from a long and successful tradition of pioneering developments in the AGL and connectivity industry. Being part of the TKH Group, our company can build on a history of more than 90 years in smart connectivity, energy distribution and AGL.

#### More information:

TKH Airport Solutions  
sales@tkh-airportsolutions.com  
www.tkh-airportsolutions.com  
+31 (0)53 57 414 56

#### Visiting address:

Elektrostraat 17  
7483 PG Haaksbergen  
The Netherlands